

The Official Newsletter  
of the  
Kansas Ornithological Society

# The Horned Lark

613 Tamerisk, Junction City, KS 66441-3359

September, 2003

Vol. 30, No. 3

## Who's Who in KOS - 2003

**President**, Tom Shane, 1706 Belmont Place, Garden City, KS 67846, shane@pld.com

**Vice-president**, Marvin Kuehn, kuehnmar@emporia.edu

**Corresponding Secretary**, Bill Busby, 626 E 1900 Road, Baldwin, KS 66006

**Membership Development Coordinator**, Mike Stewart, 1100 Wellington Drive, Leavenworth, KS 66048

**Treasurer**, Dan Larson, 3636 SE 77th Street, Berryton, KS 66409

**Board Members:**  
David Seibel, dseibel@jccc.net

Lowell Johnson, ljohnson@plantpath.ksu.edu

Cheryl Miller, avian67226@hotmail.com

Kerrie Kirkpatrick, hawkowl@earthlink.net

**Business Manager**, Dave Williams, 2708 South 23rd, Leavenworth, KS 66048  
913-772-0077, dwilliams104@kc.rr.com

**Editor, *The Bulletin***, Calvin Cink, Baker University, PO Box 65, Baldwin City, KS 66006 Calvin.Cink@bakeru.edu

**Editor, *The Horned Lark***, Chuck Otte, 613 Tamerisk, Junction City, KS 66441, 785-238-8800, otte@nqks.com

**Past-President**, Gene Young, youngg6264@yahoo.com

## From The Keyboard -

Sometimes you are struck full in the face by some thought or idea or basic awareness that may leave you saying, "Duhhh!" and yet it may have been very obvious to everyone around you. If you read any of the popular birding magazines you have probably seen the ad for a particular brand of binoculars that carries the catch phrase, "for those who are never not a birder".

It occurred to me recently that I am to that point and probably way beyond that point. I hate to admit it, but I have found myself at cemeteries for a funeral and I am listening to every bird song. I am talking with a homeowner about their yard or landscaping and all the time I'm discussing their problem, I'm listening to and watching birds. I keep lists while traveling down the highway and evaluate homes based on their potential habitat for birds and birding. I guess that I fall into that category, like many of you, of never not birding.

Like many of you I too look forward to every changing season. Mid-July rolls around and I'm thinking of shorebird and hummingbird migration. I notice hatch year birds flocking up with their parents letting us know that the breeding season has already ended for many species and migration will soon be under way. I walk out to the driveway to pick up the morning paper and I listen for the House Wren across the street and the Great-tail Grackles from down the street. I know that in just a few months, their voices will be gone from my neighborhood to be replaced by juncos or maybe Harris's Sparrows.

KOS migration takes us south this fall to Winfield. Max Thompson has a great Fall Meeting lined up. But the Fall Meeting doesn't just happen. It takes a lot of participation by you, the members, to make it a success. You need to present papers for the Paper Session or participate in the Birdwatchers Hour. Maybe this is the year you step forward to be on the KOS Board. Or maybe you're going to donate to the Silent Auction, or at least try to outbid me for something! The Fall Meeting is group participation at its finest. Plan to head to Winfield, get your registration in and make those motel reservations.

Sure, there'll be birding too. Because after all, just like myself, many of the people at the Fall Meeting are never not birding also! I'll see you in Winfield.....

Chuck

# **ANNOUNCEMENTS!**

## **Upcoming Meeting Locations**

Please note the upcoming tentative spring and fall meeting locations. Mark your calendars, look for more information in coming issues and plan to attend!

**October 3 - 5, 2003** - Winfield  
**Spring 2004** - Washington Co.  
**Fall 2004** - Baker University, Douglas County  
**Spring 2005 and Beyond** -  
Volunteers and locations needed!

Start thinking of where you'd like to go, or if you would be willing to host a spring or fall meeting. Spring meetings simply need some good bird watching areas as well as sleeping and eating establishments. Fall meetings require some place to hold meetings of around 75 to 100 people plus a location for a banquet. Contact any of the officers or board members if you have an invitation or idea for an upcoming meeting.

*In this issue -*

- 2** *Announcements*
- 3** *Opportunities and Corrections*
- 4** *KDWP Forum*
- 5** *Spring Season Birding Roundup*
- 12** *Fall Meeting Maps*
- 13** *Fall Meeting Announcement*
- 14** *Fall Meeting Accommodations*
- 15** *Fall Meeting Registration*
- 15** *Best Bird of the Year Nomination Form*
- 16** *Call for Papers*

## **KOS Items Available**

If you would like to purchase KOS T-shirts, sweatshirts, window stickers, etc. then you need to contact the KOS Business Manager, Dave Williams, at 2708 South 23<sup>rd</sup>, Leavenworth, KS 66048 (913) 772-0077, or via e-mail at [dwilliams104@kc.rr.com](mailto:dwilliams104@kc.rr.com)

## **KOS Fall Meeting Silent Auction Donations are Encouraged**

All proceeds from this event go to the KOS Student Research Fund. Any bird, birdwatching, bird feeding, etc. items are acceptable. If in doubt, bring it anyway!! Help support this worthy cause through your donations and bids!

## **Good WWW sites on a variety of topics**

### **West Nile Virus, information and reporting**

[http://www.oznet.ksu.edu/westnilevirus/report\\_bird.htm](http://www.oznet.ksu.edu/westnilevirus/report_bird.htm)

<http://www.nhm.ku.edu/birds/>

### **Mosquitoes and personal protection**

<http://www.oznet.ksu.edu/library/ENTML2/MF2571.pdf>

### **Birds and Birding in Kansas**

<http://ksbirds.org>

## **55<sup>th</sup> Meeting of the Kansas Ornithological Society Southwestern College, Winfield, Kansas October 3-5, 2003**

Details on page 13

Motel information on page 14

Registration form page 15

Call for Papers page 16

## An Opportunity To Help Protect Habitats

Dear KOS Members;

The Kansas Wildlife Federation is sponsoring a Kansas Summit to Protect Aquatic Habitats for Fish and Wildlife. It is set for Friday and Saturday, September 26 & 27. This is National Hunting and Fishing Day. It will be held in Great Bend. We are working at getting reduced rate rooms for Friday night. We are planning to offer bird watching tours and guided teal hunts for those interested. We have tentatively scheduled presentations from 9:30 am to 3:00 pm on Saturday.

We hope to inform Kansas hunters, anglers and concerned conservationists of the proposed regulatory changes. We want to generate 5,000 letters to the White House by October 31 from concerned Kansans about the proposed change.

I would like to invite the Kansas Ornithological Society to participate. We would like to involve as many active KOS members as possible to help spread the word. We could use some guides for the tours.

I am looking forward to hearing from you and working to inspire sportsmen and conservationists to counter the proposed destruction of wetlands and aquatic habitats. Please contact me for additional information.

Thank you!

Steven G. Sorensen, President  
Kansas Wildlife Federation  
9 Weatherly Ct.  
Valley Center, KS 67147-8547  
Phone (316) 755-2239  
FAX (316) 755-0321  
[webforbs@cox.net](mailto:webforbs@cox.net)

## Wanted! KOS Members Interested in Serving as Officers and Directors

Every year the Kansas Ornithological Society elects officers and board members at it's Fall (Annual) Meeting. Some years we have a lot of openings, some years most everyone is running for re-election. We normally elect two new directors every year. But we always need to know who is interested in serving on the board as an officer or director. There are usually a couple of meetings a year, one with the fall meeting one in mid winter and occasionally one with the spring meeting. We do know that we need a new Membership Development Coordinator. Mike Stewart has decided not to run for re-election. We will miss his leadership and need someone ( or more than one) who is interested in filling this slot. The "job description" follows. Please contact Tom Shane, or any of the officers, if you are interested in this position or any position on the board!

### Membership Development Coordinator

Duties:

Maintain membership database for the Society.  
Run the annual member renewal effort.  
Receive renewal and new member forms from the Treasurer.  
Print and deliver (mail) address labels to the Business Manager quarterly.  
Prepare and mail new member packets.  
Prepare semi-annual membership report (Oct-Feb).  
Correspond with members and board.

The position has two unique qualifications:  
Must be proficient in Microsoft Access 2000 or later as all member records are stored in this format. Must have capability to print labels using MS Office.

## Oops!

Due to an oversight by the editor, there was an error in the Best Birds of the Year in the March 2003 issue of the *Horned Lark*. The number 11 entry, Rufous-crowned Sparrow, first state nesting record, Barber County, was attributed to Sebastian Patti, et. al. The oversight was clarified at the Fall Meeting when the report was given, I simply neglected to correct it before publishing it in the March issue. Sebastian, et. al. DID have a county record Rufous-crowned Sparrow in Barber County for a first county record, but these birds were not nesting. The first nesting record was in **Commanche County** and the credit should go to **Chet Gresham**, et. al. Thanks to Pete and Max for straightening out this befuddled editor!

## Range Expansion of the Eurasian Collared-dove

by Helen Hands

As Lloyd Moore's maps have shown, Eurasian Collared- doves (ECDO) have been expanding quickly to towns across Kansas. Since the first Kansas sighting in 1997, ECDO have been reported from 58 counties as of May 2002. So far, I've heard of only a few sightings more than a mile outside of a town. Beyond the fact that the ECDO's name implies that they came from "Eurasia," few birders know the interesting story of how they came to the U.S. and then to Kansas. The story I'm about to tell is from two articles, one in *American Birds* (1987, pages 1370-1379 in Volume 41, Number 15) and one in *North American Birds* (1999, pages 348-353 in Volume 53, Number 4).

The first published description of the Eurasian Collared- dove was from Bulgaria in 1838. It is thought that ECDO originated in India, Sri Lanka, and Myanmar. There are conflicting reports as to whether ECDO dispersed naturally to the area around the Black and Aegean seas or if they were introduced. During the 1930s-1980s, ECDO rapidly increased in numbers and expanded their range northwest to Great Britain, southwest to Morocco, and northeast to Russia.

The ECDO's first apparent stop in the Americas was on the island of New Providence in the Bahamas in the early 1970s. The owner of a small pet store in Nassau requested some "ring-necked doves" (his term for Ringed Turtle-doves, a different species), but mistakenly received ECDO from the Netherlands. In 1974, some of the ECDO escaped in a burglary and the rest were released by the pet-store owner. It is thought that less than 50 ECDO escaped or were released. By 1986, numbers of ECDO on the island were in the tens of thousands. During the 1970s and 1980s, ECDO spread throughout the Bahamas.

By 1982, if not earlier, ECDO were nesting near Homestead and in Delray Beach, Florida. That year ECDO, Ringed Turtle-doves, and their hybrids were reported in Joliet, Illinois. By the late 1980s, ECDO had also been reported in Georgia and Arkansas. During 1991-1995, ECDO had reached as far west as Colorado and New Mexico and as far up the Atlantic Coast as North Carolina (see map). By 1999, ECDO had been reported in Kansas, as far north as Saskatchewan, and as far west as Oregon. It is unknown if all of these reported birds dispersed naturally or

were released from captivity. ECDO are kept in captivity, but are not as desirable as caged birds as the tamer Ringed Turtle-dove. Nevertheless, ECDO in North America seem to be following the same pattern of rapid range expansion and population increase as in Europe.

Because ECDO are becoming fairly common throughout Kansas, the Kansas Wildlife and Parks Commission recently approved the hunting of ECDO, as well as White-Winged and Ringed Turtle-doves. Hunters will now be able to hunt these species during the mourning dove hunting season. KDWP does not anticipate that many of these 3 species will be shot because 1) ECDO and Ringed Turtle-doves primarily occur in towns where shooting is not permitted, 2) densities of these 3 species are low compared to those of Mourning Doves, and 3) most White-Winged doves probably migrate through Kansas before the dove hunting season begins on September 1. The purpose of permitting hunting of these 3 species is to give hunters the opportunity to hunt them while their populations are increasing and their ranges are expanding.

*Helen is a Wildlife Biologist for the Kansas Dept. of Wildlife and Parks  
Helenh@wp.state.ks.us*

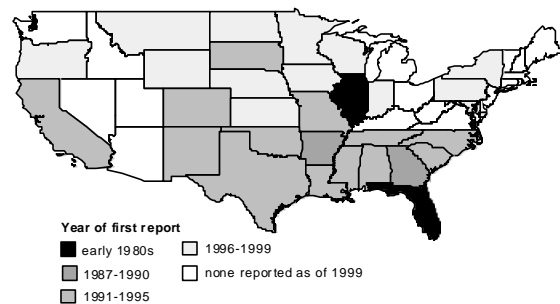

# KANSAS SPRING SEASON ROUNDUP

March 1, 2003 through May 31, 2003

By Lloyd Moore

The reporting period had some interesting birds and some mild weather through the end of May. Several observers in western Kansas reported a less than stellar warbler migration, again, and even in eastern Kansas, warbler migration was probably best described as average.

An Anhinga put in an unexpected appearance in Leavenworth much to the delight of some of the birders attending the KOS Spring Field Trip.

Black Vultures were being seen almost regularly in Cherokee county creating much discussion of whether this is the start of an "invasion" of this species as a Kansas breeder.

Shorebird numbers were anywhere

from good to incredible, depending on the day and the location. Several hundred Ruddy Turnstones were reported from Quivira and Cheyenne Bottoms. Wilson's Phalarope numbers at Quivira were estimated in excess of 20,000 in early May.

An Arctic Tern was reported from Quivira. If documentation is submitted and accepted it would only be the second record for Kansas.

We've come to expect good hummingbird records from western Kansas in the late summer period, but a Black-chinned and Calliope Hummingbird were somewhat unexpected April sightings in the western portion of the state.

A Ladder-backed Woodpecker continued to be reported from the Stockdale area of Tuttle Creek Reservoir. Western jays were still being reported from western Kansas well into April.

Thanks once again to all who have contributed their bird sightings. Keep on reporting and remember to send documentation of rare or unusual species to the Kansas Bird Records Committee (KBRC). Use either the electronic form on the KOS web site <http://www.ksbirds.org> or regular mail to Chuck Otte, KBRC Secretary

Lloyd Moore can be reached at:  
*ictinia@swbell.net*  
 or at:  
 1250 Scott Avenue  
 Kansas City, KS 66105

<u>Species</u>	<u>Comments</u>	<u>County</u>	<u>Date</u>	<u>Observers</u>
Common Loon	1 at LaCygne Lake 1 at Marion Rs. 1 at Lone Star Lake	Linn Marion Douglas	<u>05/10</u> <u>05/20</u> <u>05/20</u>	WCT AP AP
<u>Yellow-billed Loon</u>	<D> 1 at Pott. State Lake #2	Pottawatomie	04.24	DR & KSU FOC
Western Grebe	3 at Quivira NWR 4 at Quivira NWR	Stafford Stafford	05/11 05/21	MT PJ
Clark's Grebe	<D> 1 at Cheyenne Bottoms 2 at Cheyenne Bottoms 1 at Atwood sewage ponds	Barton Barton Rawlins	05/03 05/13 05/25	MP MRo,SP,MR,RMc HA
Neotropic Cormorant	1 at John Redmond Rs. 1 at Quivira NWR	Coffey Stafford	04/05 04/26	ML WnW
<u>Anhinga</u>	<D> 1 at Ft Leavenworth Bottoms	<u>Leavenworth</u>	05/03	RMc, MR, CA
Glossy Ibis	<D> 1 at Cheyenne Bottoms 1 next to Elkhart Sewage Ponds	Barton Morton	05/14 04/27	RMc,MRo,SP,MR CG
White-faced Ibis	<u>110</u> near Elkhart Sewage Ponds	Morton	04/27	CG
<u>Black Vulture</u>	<D> 2 at Schermerhorn Park <D> 1 at Schermerhorn Park 2 at Schermerhorn Park	Cherokee Cherokee Cherokee	04/26 04/28 05/09	RM, SGAS SP, CH, CG CW

(All the above sightings are most likely of the same 1-2 individuals.)

Ross's Goose	50+ at MdC W.A.	Linn	03/08	GP,MM,DS
<u>Brant</u>	1 'Black' Brant at Quivira NWR <i>(On 03/30 about 1 mile SE of QNWR in Reno Co. a Brant was found bathing in a puddle in a wheat field by Leon Hicks. This location was about 10 miles from where the Brant was seen on 03/29 so it may or may not have been the same individual.)</i>	Stafford	03/29	SS,DB,DV,WC
Trumpeter Swan	2 near Perry Lake Marina	Jefferson	03/13	PH
Tundra Swan	5 at Quivira NWR	Stafford	03/08-13	SS, M:ob
Cinnamon Teal	6 at Cheyenne Bottoms	Barton	03/16	PM,ME
	3 pair at Cheyenne Bottoms	Barton	03/24	CG
	1 pair at Quivira NWR	Stafford	03/29	SS,DB
	8 pair at Cheyenne Bottoms	Barton	03/29	DB, KS
	2 pair at Elkhart sewage ponds	Morton	04/25	CG
	1 in slough near Lawrence Airport	Douglas	05/03	GP
Greater Scaup	12 at Pony Creek Lake	Brown	03/08	MG,MD
	15 at New Strawn sewer ponds	Coffey	03/11	DG,GK
	4 at Oldsquaw Pond, Wichita	Sedgwick	03/16	CG
	1 on a farm pond	Republic	03/16	HA
	1 at Lonestar Lake	Douglas	03/17	DG
	6 at Quivira NWR	Stafford	03/24	CG
	8 at Cheyenne Bottoms	Barton	04/06	GF,BR,PY,H&AH
	2 at Marais des Cygne W.A.	Linn	05/10	CW
Surf Scoter	Pair at Quivira NWR	Stafford	05/10-19	SS, M:ob
White-winged Scoter	1 at Olathe Lake	Johnson	03/08-15	GP, M:ob
Long-tailed Duck	1 at Lonestar Lake	Douglas	04/08	GPa
Osprey	1 at Milford Lake	Clay	03/23	C&JO
	1 near Galena	Cherokee	<u>05/17</u>	SS, MR
Mississippi Kite	1 at 61 <sup>st</sup> & Antioch, Overland Park	<u>Johnson</u>	05/14	MG
Bald Eagle	Pair nesting	Osborne	03/02	HA
	Pair nesting	Rooks	03/10	HA
	1 adult, 2 young at Hillsdale Lk.	Miami	04/12	ML
	Pair with 2 young at Tuttle Crk Rs	Riley	04/14	DM
Northern Goshawk	1 in Blue Rapids	Marshall	03/21	TP
Peregrine Falcon	1 at nest box, Wichita	Sedgwick	03/27	D&FV
	1 seen at nest box in Topeka	Shawnee	03/21 & 31	JB
	1 at Baker Wetlands	Douglas	04/20	GPa
	1 at Rocky Ford, Tuttle Crk. Rs.	Pottawatomie	04/24	TC
	1 at Nature Conservancy area CB	Barton	04/26	SS, M:ob
	1 at Liberal	Seward	04/27	CG
	2 at Dry Lake	Scott	05/10	T&SSh
	2 NW corner wildlife loop QNWR	Stafford	05/10	SS, M:ob
	1 at Cheyenne Bottoms	Barton	05/10	BG
	2 in downtown Wichita	Sedgwick	05/11	BG
	1 at Tuttle Creek Rs.	Riley	05/10	TC
	1 flying over Nelson Island	Johnson	05/18	GP, DSe
	1 near Goessel	Marion	05/24	RW
Prairie Falcon	1 near Rocky Ford, Tuttle Creek Rs.	Pottawatomie	03/03	C&JO

<u>Lesser Prairie Chicken</u>	15 on a new lek about 1 mile from Seltman residence.	<u>Rush</u>	04/18	SS, DS, StS
<u>Black Rail</u>	2 at Quivira NWR	Stafford	05/13	MRo,SP,MR,RMc
	3 at Quivira NWR	Stafford	05/21	PJ
	6 at Quivira	Stafford	05/24	SS
Sandhill Crane	2 at Kingman St. Lake	Kingman	<u>05/12</u>	PJ
American Golden Plover	200 in burned prairie near Welda	Anderson	04/19	MM, GP
	2-4 at Quivira NWR	Stafford	<u>05/21</u>	PJ
Piping Plover	2 at Stockdale Area, Tuttle Crk. Rs.	Riley	04/19	GS
	1 at Clinton Lake	Douglas	05/15	DG
Whimbrel	1 at 'Bobolink Field' QNWR	Stafford	04/26	SS, M:ob
	38 at Cheyenne Bottoms	Barton	05/13	MRo,SP,MR,RMc
	9 at Quivira NWR	Stafford	05/19	AP
	18 at Quivira NWR	Stafford	05/26	GP
Long-billed Curlew	7 mi N of Garden City	Finney	03/29	T&SSh
	6 at Cheyenne Bottoms	Barton	04/06	GF,BR,PY,H&AH
	1 at Quivira NWR	Stafford	04/06	GF,BR,PY,H&AH
	8 at Kalvesta (flyover)	Finney	04/10	MR
Ruddy Turnstone	35 at Quivira NWR	Stafford	05/13	MRo,MR,SP,RMc
	<i>"Were everywhere in numbers I've never seen before, easily a few hundred! The largest single group was 45 birds at CB"</i>		05/19	AP
	50 at Cheyenne Bottoms	Barton	05/20	GP
	60+ at Quivira NWR	Stafford	05/24	SS
	1 at Lake Shawnee	Shawnee	05/30	DG
<u>Red Knot</u>	2 at Quivira NWR	Stafford	05/24	SS
Sanderling	<u>150</u> at Cheyenne Bottoms	Barton	05/13	MRo,SP,MR,RMc
	50 at Quivira NWR	Stafford	05/24	SS
Dunlin	20 at Quivira NWR	Stafford	05/24	SS
Buff-breasted Sandpiper	15 in field between Wilson and Blackwolf Ellsworth		05/06	MR
	1 at Konza Prairie	Riley	05/09	BS
	5 NE of Minneola	Clark	05/23	GP
	20 in Prairie Dog town S of Redwing	Barton	05/19	AP
Wilson's Phalarope	<u>20-25,000</u> at Quivira NWR	Stafford	05/11	MT
Red-necked Phalarope	1 at Cheyenne Bottoms	Barton	05/13	MRo,SP,MR,RMc
	1 at Linn sewage ponds	Washington	05/14	DT
	2 at Quivira NWR	Stafford	05/20	GP
	3 at Cheyenne Bottoms	Barton	05/18	MC, GA
	5 at Quivira NWR	Stafford	05/21	PJ
Laughing Gull	1 at Unit G, MdCWA	Linn	05/10	CW
	1 at Clinton Lake	Douglas	05/11	AS
Glaucous Gull	1 adult, Clinton Lk.	Douglas	03/02	AP
	1 2 <sup>nd</sup> winter at Clinton Lk.	Douglas	03/09	DG
<u>Great Black-backed Gull</u>	1 <sup>st</sup> summer at Pott. St. Lk. #2	Pottawatomie	04/25	KK, GS, DR
Common Tern	1 at Quivira NWR	Stafford	05/21	PJ
<u>Arctic Tern</u>	1 at Big Salt Marsh, QNWR	Stafford	05/12	CW, MR

Least Tern	2 at Quivira NWR	Stafford	05/13	MRo,SP,MR,RMc
	1 at Linn sewage ponds	Washington	05/15	DT
	20+ at Quivira NWR	Stafford	05/24	SS
Eurasian Collared-Dove	? # in Bogue	Graham	03/10	HA
	3 in Colby	Thomas	03/15	DL
	1 in Clay Center	Washington	03/24	DT
	1 in Salina	Saline	03/23	MR
	<D> 1 in Valley Center	Sedgwick	04/19	VM
	Pair nesting in NW Wichita	Sedgwick	04/14	PJ
	1 in Wilson	Ellsworth	04/14	MR
	1 at Rader res. in Kensington	Smith	04/20	MR
	Many in Ellinwood & Great Bend	Barton	04/25-27	SS, M:ob
	2 in Manhattan	Riley	05/06	DM
2 in Ulysses	Grant	05/07	KH, SG	
2 at Galena	Cherokee	05/17	SS, GP	
White-winged Dove <D>	1 at Elkhart	Morton	04/25-27	SP,CH,CG
	2 at Shane res., Garden City	Finney	04/28	T&SSh
Inca Dove	1 at zoo directors res. Garden City	Finney	03/31	DBa
	1 at McClard res., Wichita	Sedgwick	05/12	BM
Greater Roadrunner	Nesting in southern Meade Co.	Meade	05/01	TF
Barn Owl	1 at Scott State Park	Scott	03/22	T&SSh
	1 at Cheyenne Bottoms	Barton	03/24	CG
Burrowing Owl	5 near Holcomb	Finney	03/29	T&SSh
Barred Owl	1 at Clark Co. State Lake	<u>Clark</u>	05/22	GP
Long-eared Owl	8 at farmstead	Pawnee	03/10	SS
	1 at Scott State Park	Scott	03/22	T&SSh
	1 adult, 4 young Kanopolis St. Pk.	Ellsworth	05/27	BG
Black-chinned Hummingbird <D>	Adult male in Rolla	Morton	<b>04/24</b>	SP,CH
<b><u>Calliope Hummingbird</u></b> <D>	1 adult male at Garden City res.	Finney	<b>04/04-08</b>	MO
Ladder-backed Woodpecker	1 female at Stockdale Area, Tuttle Creek Rs.	<b><u>Riley</u></b>	05/08	LJ, M:ob
	<D> 1 female at Stockdale Area	<b><u>Riley</u></b>	03/10	JR
Yellow-bellied Flycatcher	1 at Kill Creek Park	Johnson	05/13	MG
	3 in Galena area	Cherokee	05/17	SS, MR
	1 at Overland Park Arboretum	Johnson	05/23	DSe
	1 at Ft Leavenworth	Leavenworth	05/25	DW
	1 at Marlatt Park, Manhattan	Riley	05/26	GS
Say's Phoebe	Nest with young NW of Buffalo	<u>Harper</u>	05/13	JS
Ash-throated Flycatcher <D>	Pair nesting, Wilburton Crossing	Morton	04/26	SP,CH,CG
Northern Shrike	1 Stockdale Area, Tuttle Crk. Rs.	Riley	03/01	LJ
	1 2 mi. S of Kingman St. Lk.	Kingman	03/08	PJ
Steller's Jay	1 at residence in Meade	Meade	<b>04/24</b>	TF
	(Present since 01/26 at the Ackerman residence) 1 at farmstead	Ford	<b>04/28</b>	fide DK



Western Scrub-Jay <D>	5 in Hugoton	Stevens	<u>04/24</u>	SP, CH
	8 from Boy Scout area to K-27	Morton	<u>04/25</u>	SP, CH
	3 at Richfield, 1 at Elkhart	Morton	<u>04/26</u>	CG
Pinyon Jay	5-12 at feeder in St. Francis <i>(Pinyon Jays were present at several locations in St. Francis during the winter and spring months, with as many as 30 at one location near the fairgrounds.)</i>	Cheyenne	03/10	HA
Fish Crow	1 at Elk City W.A.	Montgomery	04/20	MP
Mountain Bluebird	50 NE of Wilmore	Comanche	03/07	GF
	30+ N of Ashland	Clark	03/07	GF
Townsend's Solitaire	1 at Otoe Area, Wilson Lake	Russell	04/09	MR
Veery	1 at Burcham Pk., Lawrence	Douglas	05/09	RA
Sprague's Pipit	1 at Cheyenne Bottoms	Barton	04/27	MG, M:ob
	1 in field 9 mi NW of Larned	Pawnee	05/01	SS
Blue-winged Warbler	1 old Lone Star Cement Plant area	Wyandotte	05/11	CW
Golden-winged Warbler	1 old Lone Star Cement Plant area	Wyandotte	05/11	CW
	1 on Nelson Island	Johnson	05/19	GP, DSe
Cape May Warbler	1 at Antioch Park	Johnson	05/12	AS
	1 at Tuttle Creek Outlet Park	Riley	05/16	GS
	1 at Ft. Leavenworth	Leavenworth	05/17	DW
	1 at Galena	Cherokee	05/18	SS, MR
Black-throated Blue Warbler	1 male at Oak Park, Wichita	Sedgwick	05/04	RB
	1 at Ft. Leavenworth	Leavenworth	05/17	DW
'Audubon's' Warbler	3 near Covert	Osborne	04/19	SS
Black-throated Gray Warbler	1 at Elkhart cemetery	Morton	04/26	CG
Townsend's Warbler	1 at Garden City zoo	Finney	04/30	DBa,T&SSh, MRa
Yellow-throated Warbler	3 at Ft. Leavenworth bottoms	Leavenworth	04/05	JS
	2-3 at Caney River bridge	Chautauqua	04/05	PJ, WAS
	1 at Mdc W.A.	Linn	04/12	MM
	2 territorial at MdCWA	Linn	04/19	MM, GP
	1 S of Lone Star Town	Douglas	05/05	AP
	2 territorial Lone Star Cement Rd.	Wyandotte	05/23	DSe
Bay-breasted Warbler	1 at residence in Lenexa	Johnson	05/06	NF
	1 at Quivira NWR	Stafford	05/07	GS
	1 at Annenberg Pk., Manhattan	Riley	05/08	DR, KSUFOC
	1 at Timber Canyon, Scott Lake	Scott	05/10	T&SSh
	1 old Lone Star Cement Plant area	Wyandotte	05/11	CW
	1 at Ft Leavenworth	Leavenworth	05/10	DW, NL
	3 at Nelson Island	Johnson	05/18	GP, DSe
	1 at Galena	Cherokee	05/18	SS, MR
	1 at Camp Naish	Wyandotte	05/26	WCT, AG
Cerulean Warbler	1 at Ft. Leavenworth Bottoms	Leavenworth	05/25	JS, B&CB
Pine Warbler	1 at Chisholm Crk. Pk., Wichita	Sedgwick	04/29	ST, DV
Prairie Warbler	1 at CNG Workstation	<u>Morton</u>	04/27	CG
	1 at Quivira NWR	<u>Stafford</u>	05/03	RW
	1 at Galena	Cherokee	05/18	SS, MR

Worm-eating Warbler	1 at Garden City Zoo	<b>Finney</b>	04/30	DBa	
	1 near RR bridge, river road. Mdc	Linn	05/10	CW	
	1 old Lone Star Cement Plant area	Wyandotte	05/11	CW	
	1 at Overland Park Arboretum	Johnson	05/21	NL, HHe	
MacGillivray's Warbler	1 on St. Francis River Walk	Cheyenne	05/25	HA	
Hooded Warbler	1 at Oak Park, Wichita	<b>Sedgwick</b> 05/02	PJ		
	1 old Lone Star Cement Plant area	Wyandotte	05/11	CW	
Green-tailed Towhee	1 at CNG Workstation	Morton	04/27	CG	
	1 at feeder in Garden City	Finney	05/07	T&SSh	
Cassin's Sparrow	3 SW corner of county	Stafford	05/10	SS	
Baird's Sparrow	1 singing in pasture near Udall	Cowley	04/19	PJ, CG	
	1 in field 9 mi NW of Larned	Pawnee	05/01	SS	
Fox Sparrow	1 ' <i>schistacea</i> ' race	Pawnee	03/10	SS	
<u>Golden-crnd Sparrow</u> <D>	1 at Quivira NWR	Stafford	04/27	GF	
'White-winged' Junco	1 at Rintoul residence	Riley	03/16	DR	
	1 at Scott State Park	Scott	03/22	T&SSh	
Black-headed Grosbeak	1 male at feeder W of Linn	Washington	05/06	DT	
	2 males at feeder in Garden City	Finney	05/07	T&SSh	
	4 M & 1 F at Garden City feeder	Finney	05/09	T&SSh	
	1 N of Colwich	Sedgwick	05/10	PJ	
	1 along Wildcat Creek, Manhattan	Riley	05/10	GS, et al	
	1 at Cable res. Tuttle Creek Rs.	Riley	05/21	TC	
Lazuli Bunting	1 at Cowley Co. St. Lk.	Cowley	04/28	LH,CS	
	1 at feeder in Shawnee	Johnson	05/03	NC	
	1 at feeder in Cawker City	Mitchell	05/06	HA	
	2 at feeder in Garden City	Finney	05/06	T&SSh	
	1 at feeder in Cawker City	Mitchell	05/07	HA	
	<i>(Different bird than one on 5/6)</i>				
	1 at residence in Washington	Washington	05/08	JY	
	6 males at Garden City feeder	Finney	05/09	T&SSh	
	1 at Chisholm Creek Pk., Wichita	Sedgwick	05/09	PM	
	1 at Linear Pk., Manhattan	Riley	05/10	GS, et al	
	Several ? near Seward	Stafford	05/10	DK	
	?# near Ogden	Riley	05/10	HH	
	4 at Conover res. in Satanta	Haskell	05/11	J&NC	
	1 at Kazmaier res., Larned	Pawnee	05/11	DK	
	1 at feeder S of Wilson	Russell	05/13	DKI	
	1 at residence Tuttle Creek Rs.	Pottawatomie	05/18	G&DS	
	1 at Wilson State Park	Russell	05/16	MR	
	1 at res. S of Lone Star	Douglas	05/18	AP	
	1 on NW side Tuttle Creek Rs.	Riley	05/24	GSu	
	1 in Linear Park, Manhattan	Riley	05/26	GS	
1 in Tuttle Cove State Park	Riley	05/27	LJ		

*(The following is a list, provided by Tom Shane, of Lazuli Bunting sightings at the Shane residence in Garden City, Finney Co. between 6 – 17 May this year.)*

Lazuli Bunting High Counts for a Garden City, KS Yard During the May 2003 Migration, Male (M) and Female (F.)

May 6...2M  
 May 7...3M  
 May 8...6M  
 May 9...6M,1F  
 May 10...10M,2F  
 May 11...5M  
 May 12...3M,1F  
 May 13...4M,2F  
 May 14...3M,2F  
 May 15...2M,2F  
 May 16...3M,2F  
 May 17...1M

Red Crossbill	<D> 1 at residence in NW Miami Co.	Miami	05/22-25	RZ
Painted Bunting	1 at Walla Walla area	Junction City	05/10	C&JO
	1 at Cable res., Tuttle Crk, Rs.	Riley	05/10	TC
	1 at Clinton State Park	Douglas	05/13	GPa
	2 at Wakarusa Arm Causeway at Clinton Lake	Douglas	05/31	DSe, GP, MM
Yellow-headed Blackbird	<u>300</u> near Peabody	Marion	04/29	KKi
Lesser Goldfinch	<D>1 at K-State Research Center.	Finney	05/26	CE

Underlined dates, locations or comments indicate unusual, late or early sightings.

Underlined species indicates unusual species.

**Underlined species in bold** indicate species with no records or fewer than 10 records for Kansas.

<D> indicates that documentation was submitted to KBRC (Kansas Bird Records Committee).

**Abbreviations:** Cimarron National Grassland (CNG), Kansas Bird Records Committee (KBRC), Nelson Environmental Study Area (NESA), Quivira National Wildlife Refuge (QNWR), Cheyenne Bottoms (CB), Perry Wildlife Area (PWA), Marais des Cygne W. A. (MdcWA), Ft. Hays State University (FHSU), KSU Field Ornithology Class (KSU FOC),

**OBSERVERS:** Henry Armknecht, Charles Anderson, Robert Antonio, Greg Anderson, Dan Baffa (DBa), Roy Beckemeyer, Joanne Brier, Dave Bryan, Bill & Colin Busby (B&CB), Ted Cable, Wally Champeny, Nancy Clark, Jack & Norma Conover (J&NC), Mark Corder, Mary Deuser, Marsha Ebaugh, Cindy Elliott, Tom Flowers, Gregg Friesen, Nancy Fitzgerald, Matt Gearheart, Dan Gish, Chet Gresham, Sam Guy, Alan Godwin, Harvey & Allison Hiebert (H&AH), Leon Hicks, Chris Hobbs, Hoogy Hoogheem, Helen Hewins (HHe), Pete Janzen, Lowell Johnson, Don Kazmaier, Dave Klema (DKI), Glen Koontz, Kellye Hart, Karl Kosciuch, Kerrie Kirkpatrick (KKi), Paul Lehman, Mark Land, Dan Larson, Nancy Leo, Mick McHugh, Roger McNeill (RMc), Bert McClard, Patty Marlett, Vince Marshall, Robert Mangile, Dan Mulhern, Chuck & Jaye Otte (C&JO), Marie Osterbuhr, Tom Parker, Gerry Parkinson (GPa), Michael Patten, Sebastian Patti, Galen Pittman, Alexis Powell, Mike Rader, Bob Regier, Dave Rintoul, Mark Robbins (MRo), Jethro Runco, Mike Ramsey (MRa), John Schukman, Carolyn Schwab, Brett Sandercock, David Seibel (DSe), Scott Seltman, Diane Seltman, Steve Seltman (StS), Kent Seltman, Tom & Sara Shane (T&SSh), Greg Schrott, Gibran Suleiman (GSu), Sperry-Galligar Audubon Society (SGAS), Art Swalwell, Gary & Donna Shaver (G&DS), Dan Thalmann, Will Chatfield Taylor (WCT), Wichita Audubon Society (WAS), Dan Thalmann, Sandra Tholen, Max Thompson, Don Vannoy, Don & Fran Vannoy (D&FV), Ron Wedel, Dave Williams, Wings n Wetlands (WnW), Chris Wood, Perry Yoder, James Yungeberg, Ron Zimmerman

**Remember KOS...** If you would like to help the Kansas Ornithological Society's future growth consider leaving a memorial trust for the Society or including the KOS in your will. If you would like more information feel free to contact any of the Board Members.

# Where is Southwestern College located?

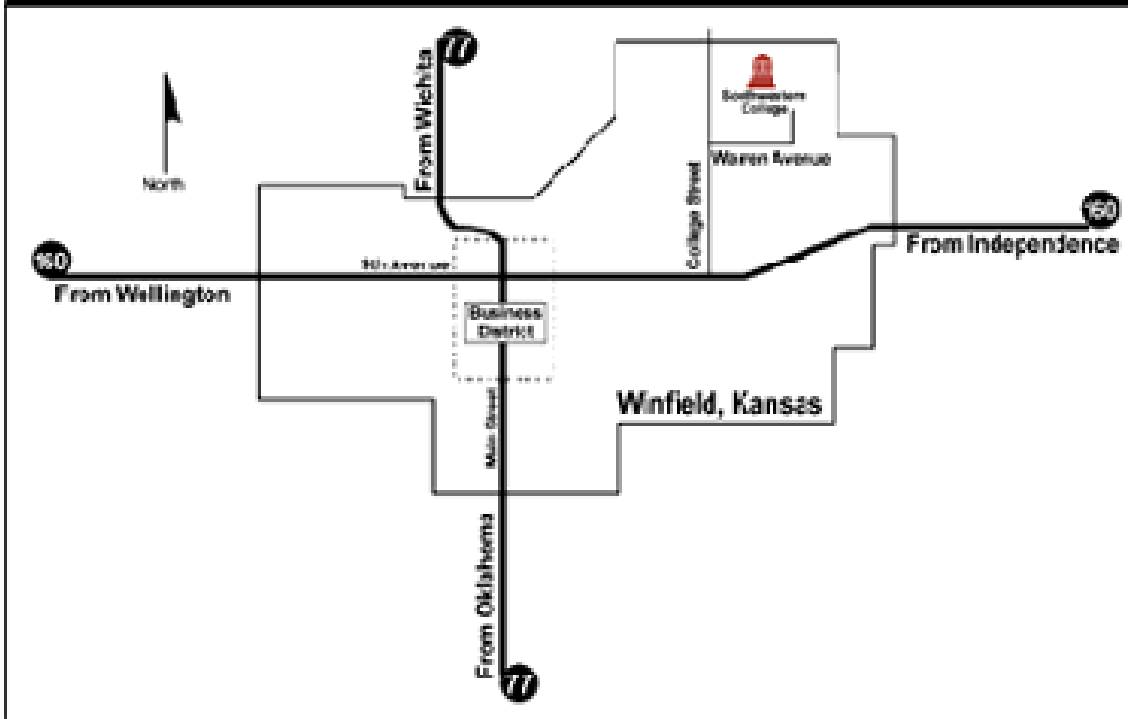

# Southwestern College Campus Map

Winfield, Kansas

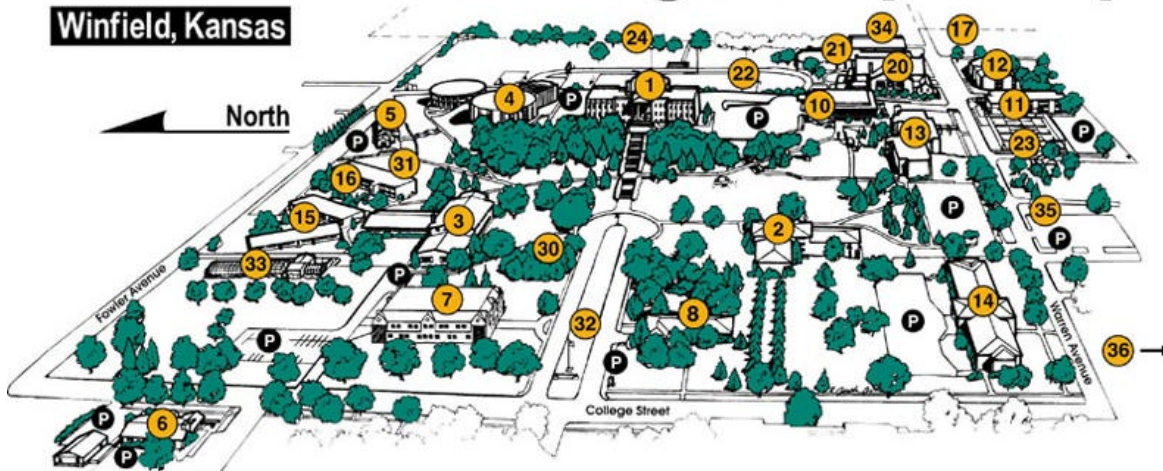

### Academic/Administrative

1. Christy Administration Bldg. & Richardson Auditorium
2. Memorial Library
3. Mossman Hall
4. Darbeth Fine Arts Center & Messenger Recital Hall
5. Wroten Hall & McEwen Place
6. Center for Teaching Excellence (teacher education program)
7. Beech Science Center & Mabee Laboratory Complex
8. Welcome Center (Office of Admission)

### Student Life Buildings

10. Roy L. Smith Student Center (bookstore, dining hall, and snack bar)
11. Sutton Residence Hall & Sutton Center (student life)
12. Reid Apartments
13. Wallingford Residence Hall
14. Broadhurst Residence Hall
15. Honor Apartments
16. Shriwise Apartments
17. Warren Avenue Apartments

### Athletic Facilities

20. Stewart Field House
21. White Physical Education Bldg.
22. Sonner Stadium, Kohler Field, Morony Track, & Caywood Special Events Area
23. Bob Hower & Don Cooper Tennis Courts
24. Soccer Field

### Other Facilities

30. The Mound
31. The Allen Podium
32. Heritage Rock
33. Ruth Warren Abbott Greenhouse
34. Dixon Operations Center
35. Le Chat Noir (coffee house)
36. Grace Little Builders Preschool

**P** Parking

**55<sup>th</sup> Meeting of the Kansas Ornithological Society**  
***Southwestern College, Winfield, Kansas***  
**October 3-5, 2003**

The Kansas Ornithological Society will meet at Southwestern College, in Winfield, Kansas, on October 3, 4, and 5, 2003. Southwestern College is located in northeast Winfield, at the intersection of Warren and College St. Maps showing the location of the campus and the campus layout are on the facing page. All activities will take place on the campus. The Friday evening reception and workshop will take place in the Beech Science Center on College St. (#7 on Campus Map). The paper sessions will take place in Messenger Auditorium in Darbeth Hall (#4). The banquet will take place at the Roy L. Smith Student Center (#10).

**Members are encouraged to bring donated items for the Silent Auction.** All proceeds from this event go to the KOS Student Research Fund.

Members are also encouraged to bring bird-related photos, videos, and/or recordings to share with other members during the informal birdwatchers hour after lunch. Let us know if you have material to share for the Birdwatcher's Hour. We request that presentations be limited to 10 minutes.

**PROGRAM**

**Friday, October 3**

7:00-9:00 p.m. Informal reception and identification workshop at Beech Science Center.

**Saturday, October 4**

6:30-8:00 Morning bird walk.

8:00-10:00 Registration in the foyer of Messenger Hall. View Silent Auction items in the President's Gallery in Darbeth Hall. The Silent Auction will run throughout the day, with all bids final at 5:00 p.m.

9:00-11:30 Morning Paper Session – Messenger Auditorium

11:30-12:00 Morning Business Session

12:00-1:00 Lunch on your own. The college dining hall has a brunch buffet for about \$4.00. All other restaurants are 1-2 miles away. A room has been reserved for the Director's Meeting.

1:00-2:00 Birdwatchers hour – Messenger Auditorium

2:00-4:30 Afternoon Paper Session – Messenger Auditorium

4:30-5:00 KOS Business Meeting

6:30-9:00 Banquet, Best Birds of the Year, Resolutions, and Guest Speaker Dr. Richard Prum. Rick will talk about "How feathers grow and why that is so cool". He has been directing much of his research in the area of feathers. The banquet is in the Roy L. Smith Student Center main dining hall. The banquet will be served buffet style. Dinner includes dessert, beverage, and a two meat buffet.

**Sunday, October 5**

6:30-12:00 Field trips to local birding locations. All trips depart from the SC campus Beech Science Center.

12:00-1:00 Lunch and compilation at the picnic pavilion at Black Creek Park just off the south bypass around Winfield. Boxed lunches will be available from Mr. Goodcents Sub Shop.

**We request that registrations be received by September 25 if possible. This will help the meal planners.**

**Accommodations Information**  
**KOS Meeting**  
**October 3-5, 2003**  
**Winfield, KS**

<u>MOTEL*</u>	<u>Telephone</u>	<u>Single</u>	<u>Double</u>	<u>Triple</u>
Camelot Motor Inn	620-221-9050	\$45.00	\$52.00	

**We are holding 12 rooms here until September 1. They are being held under Max Thompson.**

Comfort Inn	620-221-7529	\$67.50	\$76.90	
-------------	--------------	---------	---------	--

The Comfort Inn is booked for October 4 and unless some rooms open up, you will not get reservations there.

Sonner Motor Inn	620-221-4400	\$45.00	\$50.00	
------------------	--------------	---------	---------	--

Super 8 Motel Indoor Pool	620-229-8888	\$60.84	\$65.60	
------------------------------	--------------	---------	---------	--

Town House Motel	620-221-2110	\$32.00	\$36.00	\$38.00
------------------	--------------	---------	---------	---------

CAMPING

Winfield City Lake      \$8.00 Electrical Hookup plus \$4.00 for your car per day.  
                                      \$2.00 Primitive plus \$4.00 for your car for your car per day

Winfield Fairgrounds      \$6.00 Electrical Hookup per day  
                                      \$3.00 Primitive per day

\*All motels have a 10.3% tax.

**THERE IS A LARGE WEDDING IN TOWN THAT BOOKED THE COMFORT INN. ALSO THAT WEEKEND IS THE ARTS AND CRAFT FAIR AT THE FAIRGROUNDS AND ART IN THE PARK IN ISLAND PARK. I WOULD ADVISE MAKING YOUR RESERVATIONS SOON!**

**RELEASE**

Please read and sign. This release must be signed before the registration can be accepted.

Each registrant named, both adult and minor, desires to participate in the field trips and other activities at this meeting of the Kansas Ornithological Society (KOS). Therefore, each registrant knowingly and voluntarily grants to the KOS and their officers, committee members, and any other persons engaged in activities in connection with this meeting, a full release from any claim, liability, or cost of any nature on account of personal illness or bodily injury, loss of life, or loss or damage to property directly or indirectly arising out of the registrants participation in this meeting.

Name (print) \_\_\_\_\_ Name (print) \_\_\_\_\_

Signature \_\_\_\_\_ Signature \_\_\_\_\_

Date \_\_\_\_\_ Date \_\_\_\_\_

*(attach additional names and signatures as necessary)*



**KANSAS ORNITHOLOGICAL SOCIETY  
FALL 2003 MEETING  
CALL FOR PAPERS**

**SATURDAY, OCTOBER 4, 2003  
SOUTHWESTERN COLLEGE  
WINFIELD, KANSAS**

The fall meeting of the KOS for 2003 will be held in Winfield. Paper sessions will take place in the morning and afternoon of Saturday, 4 October, in Messenger Auditorium, Darbeth Hall. Audio/visual equipment includes 35 mm slides, VHS video, and computer projection. Papers on any topic of interest to Kansas ornithologists and birdwatchers are requested. Our paper sessions traditionally include both technical and general interest presentations. Student papers will be judged and the best paper announced at the banquet Saturday night. All student presenters will receive a year's free membership in KOS.

Please submit your abstract by mail, e-mail or fax to:

Marvin D. Kuehn  
Emporia State University  
1200 Commercial - Campus Box 4036  
Emporia, Kansas 66801

Off: 620-341-5795  
Fax: 620-341-6200  
Home: 620-342-9133  
kuehnmar@emporia.edu

Submissions should include:

Title of Paper: \_\_\_\_\_

Authors and affiliations: \_\_\_\_\_

---

Estimated time in minutes: 10 \_\_\_ 15 \_\_\_ 20 \_\_\_

Audio/visual: Slides: \_\_\_ Video: \_\_\_ Computer projection \_\_\_ Overhead: \_\_\_

If using computer projection: Bringing my own laptop (preferred): \_\_\_ Need a computer: \_\_\_

ABSTRACT: \_\_\_\_\_

\_\_\_\_\_

\_\_\_\_\_

\_\_\_\_\_

\_\_\_\_\_

\_\_\_\_\_

\_\_\_\_\_

**PLEASE SUBMIT ABSTRACTS NO LATER THAN 1 SEPTEMBER 2003!**

---